

## CROMMELINS™ AR505RLW

### OPERATION & INSTRUCTION MANUAL

Thank you for your selection of a CROMMELINS™ AR505RLW Pressure Cleaner. This Operation Manual explains its use, installation, checking and maintenance. We highly recommend that you retain this manual for ready reference regarding proper handling of the CROMMELINS™ AR505RLW Pressure Cleaner.



#### SPARE PARTS & SERVICE

Phone: 1300 554 524 Freecall Fax: 1800 636 281

[spareparts@crommelins.com.au](mailto:spareparts@crommelins.com.au) [www.crommelins.com.au](http://www.crommelins.com.au)

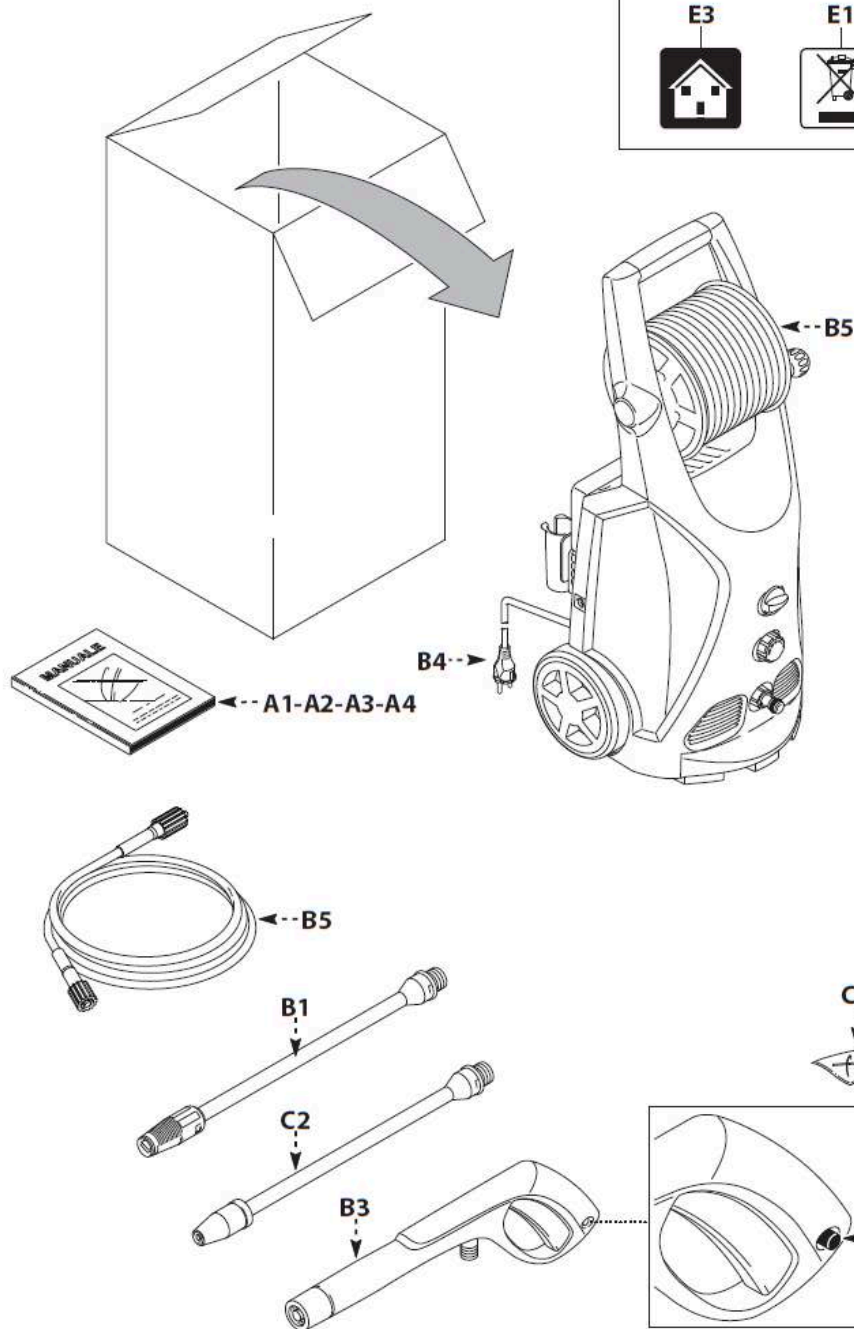
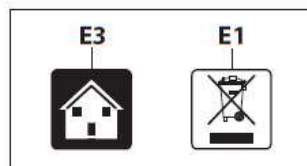

1

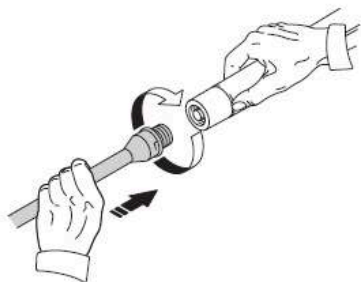

2

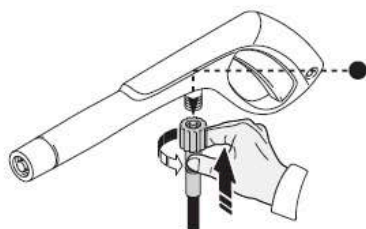

3

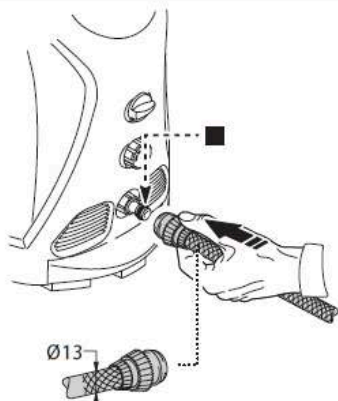

4

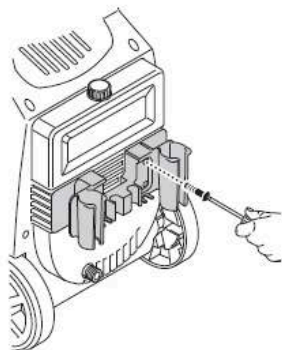

5

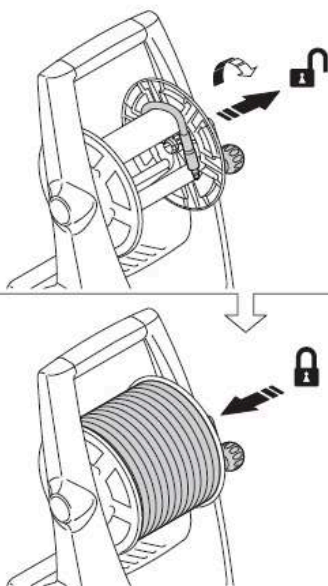

6

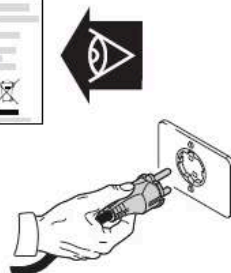

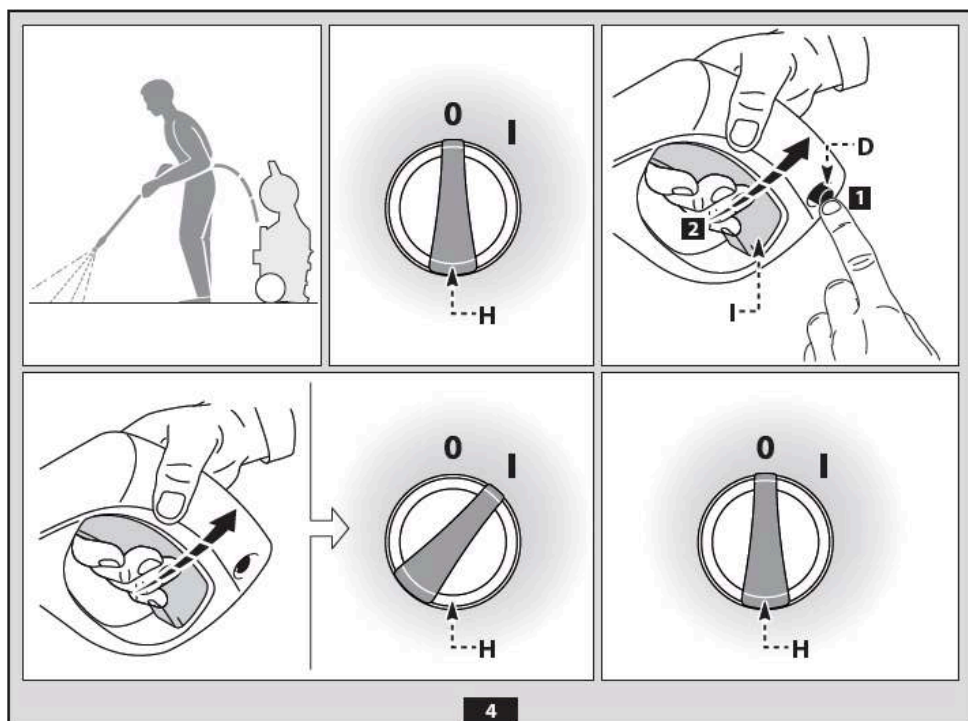
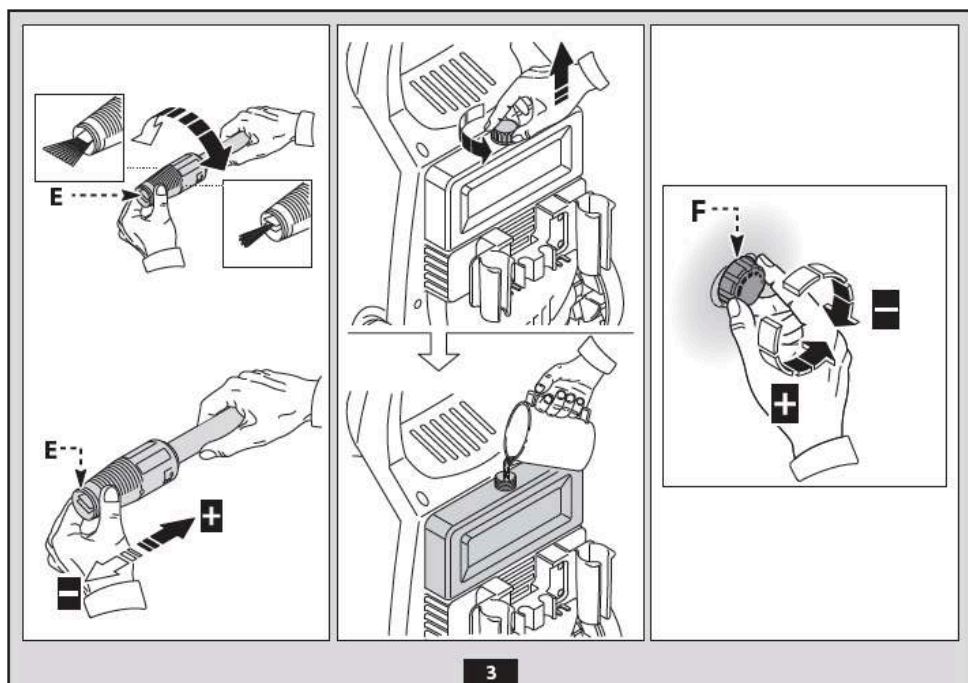

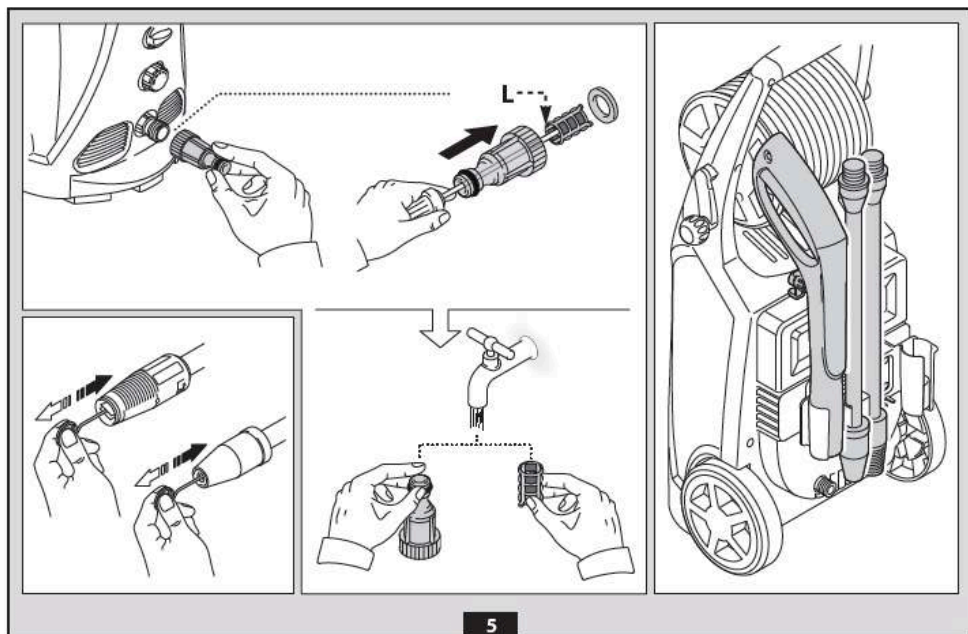

5

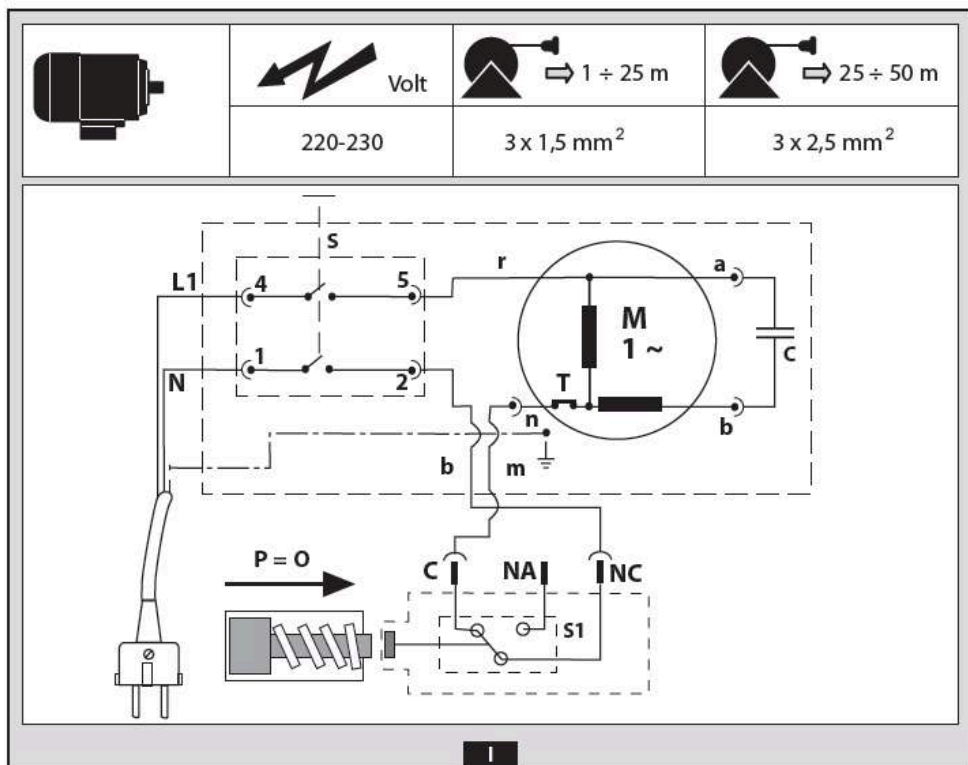

I

























## 1 SAFETY INSTRUCTIONS



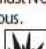











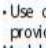









- 1.1 The appliance you have purchased is a technologically advanced product designed by one of the leading European manufacturers of high pressure pumps. To obtain the best performance from your unit, read this booklet carefully and follow the instructions each time you use it. During connection, use and servicing of the appliance, take all possible precautions to protect your own safety and that of the people in the immediate vicinity. Read the safety regulations carefully and comply with them on all occasions; failure to do so may put health and safety at risk or cause expensive damage.

## 2 SAFETY RULES/RESIDUAL RISKS

### 2.1 SAFETY "MUST NOTS"

- 2.1.1     **EXPLOSION OR POISONING HAZARD.** DO NOT use the appliance with inflammable or toxic liquids, or any products which are not compatible with the correct operation of the appliance.
- 2.1.2   **INJURY HAZARD.** DO NOT direct the water jet towards people or animals.
- 2.1.3   **ELECTRIC SHOCK HAZARD.** DO NOT direct the water jet towards the unit itself, electrical parts or towards other electrical equipment.
- 2.1.4  **SHORT CIRCUIT HAZARD.** DO NOT use the appliance outdoors when it is raining.
- 2.1.5  **INJURY HAZARD.** DO NOT allow children or incompetent persons to use the appliance.
- 2.1.6   **ELECTRIC SHOCK HAZARD.** DO NOT touch the plug and/or socket with wet hands.
- 2.1.7   **ELECTRIC SHOCK AND SHORT CIRCUIT HAZARD.** DO NOT use the appliance if the electrical cable is damaged.
- 2.1.8   **EXPLOSION HAZARD.** DO NOT use the appliance if the high pressure hose is damaged.
- 2.1.9  **ACCIDENT HAZARD.** DO NOT jam the trigger in the operating position.
- 2.1.10  **ACCIDENT HAZARD.** Check that the data plates are affixed to the appliance, if not, inform your dealer. Units without plates must NOT be used as they are unidentifiable and potentially dangerous.
- 2.1.11   **EXPLOSION HAZARD.** DO NOT tamper with or adjust the setting of the safety valve or the safety devices.
- 2.1.12  **HAZARDOUS ALTERATION OF OPERATING PERFORMANCE.** DO NOT alter the original diameter of the spray head nozzle.
- 2.1.13  **ACCIDENT HAZARD.** DO NOT leave the appliance unattended.
- 2.1.14  **SHORT CIRCUIT HAZARD.** DO NOT move the appliance by pulling on the **ELECTRICAL CABLE**.
- 2.1.15 Make sure that cars do not drive over the high pressure hose.
- 2.1.16 **EXPLOSION HAZARD.** DO NOT move the appliance by pulling on the high pressure hose.
- 2.1.17 **EXPLOSION HAZARD.** When directed towards tyres, tyre valves or other pressurised components, the high pressure jet is potentially dangerous. Do not use the rotating nozzle kit, and always keep the jet at a distance of at least 30 cm during cleaning.

### 2.2 SAFETY "MUSTS"

- 2.2.1  **SHORT CIRCUIT HAZARD.** All electrical conductors **MUST BE PROTECTED** against the water jet.
- 2.2.2   **ELECTRIC SHOCK HAZARD.** The appliance **MUST ONLY BE CONNECTED** to an adequate power supply in compliance with all applicable regulations (IEC 60364-1).
-  The appliance may cause network noise **DURING** startup.
-  Use of a safety residual current circuit-breaker (R.C.C.B.) will provide additional protection for the operator (30 mA). Models supplied without plug must be installed by qualified staff. Use only authorized electrical extension leads with suitable conductor gauge.
- 2.2.3        **INJURY HAZARD.** High pressure may cause parts to rebound: wear all the protective clothing and equipment needed to ensure the operator's safety.
- 2.2.4  **ACCIDENTAL START-UP HAZARD.** Before doing work on the appliance, **REMOVE** the plug.
- 2.2.5  **INJURY HAZARD.** Before pressing the trigger, **GRIP** the gun firmly to counteract the recoil.
- 2.2.6   **CONTAMINATION HAZARD.** **COMPLY WITH** the requirements of the local water supply company. According to DIN 1988, the appliance may only be connected to the mains drinking water supply if a backflow preventer valve with drain facility is installed in the supply hose.
- 2.2.7  **ACCIDENT HAZARD.** Maintenance and/or repair of electrical components **MUST** be carried out by qualified staff.
- 2.2.8  **INJURY HAZARD.** **DISCHARGE** residual pressure before disconnecting the unit hose.
- 2.2.9  **ACCIDENT HAZARD.** Before using the appliance, **CHECK** every time that the screws are fully tightened and that there are no broken or worn parts.
- 2.2.10     **EXPLOSION AND ELECTRIC SHOCK HAZARD.** **ONLY USE** detergents which will not corrode the coating materials of the high pressure hose/electrical cable.
- 2.2.11   **INJURY HAZARD.** **ENSURE** that all people or animals keep a minimum distance of 16 yd. (15m) away.

### 3 GENERAL INFORMATION (FIG.1)/PAGE 3

#### 3.1 Use of the manual

This manual forms an integral part of the appliance and should be kept for future reference. Please read it carefully before installing/using the unit. If the appliance is sold, the Seller must pass on this manual to the new owner along with the appliance.

#### 3.2 Delivery

The appliance is delivered partially assembled in a cardboard box. The supply package is illustrated in fig.1.

##### 3.2.1 Documentation supplied with the appliance

- A1 Use and maintenance manual
- A2 Safety instructions
- A3 Declaration of conformity
- A4 Warranty regulations

#### 3.3 Disposing of packaging

The packaging materials are not environmental pollutants but must still be recycled or disposed of in compliance with the relevant legislation in the country of use.

#### 3.4 Safety signs

Comply with the instructions provided by the safety signs fitted to the appliance.

Check that they are present and legible; otherwise, fit replacements in the original positions.



E1 symbol – Indicates that the appliance **must not be disposed of** as municipal waste; it may be handed in to the dealer on purchase of a new appliance. The appliance's electrical and electronic parts must not be reused for improper uses since they contain substances which constitute health hazards.



E2 symbol – Indicates that the appliance is intended for professional use, i.e. for experienced people informed about the relative technical, regulatory and legislative aspects and capable of performing the operations necessary for the use and maintenance of the appliance.



E3 symbol – Indicates that the appliance is intended for non-professional (domestic) use.

### 4 TECHNICAL INFORMATION (FIG.1)/PAGE 3

#### 4.1 Envisaged use

This appliance has been designed for individual use for the cleaning of vehicles, machines, boats, masonry, etc., to remove stubborn dirt using clean water and biodegradable chemical detergents.

Vehicle engines may be washed only if the dirty water is disposed of as per regulations in force.

- Intake water temperature: **see data plate on the appliance.**
- Intake water pressure: **min. 0,1 MPa-max 1 MPa.**
- Operating ambient temperature: **above 0°C.**

The appliance is compliant with the EN 60335-2-79/A1 standard.

#### 4.2 Operator

The symbol on the front cover identifies the appliance's intended operator (professional or non-professional).

#### 4.3 Improper use

Use by unskilled persons or those who have not read and understood the instructions in the manual is forbidden.

The introduction of inflammable, explosive and toxic liquids into the appliance is prohibited.

Use of the appliance in a potentially inflammable or explosive atmosphere is forbidden.

The use of non-original spare parts and any other spare parts not specifically intended for the model in question is prohibited.

All modifications to the appliance are prohibited. Any modifications made to the appliance shall render the Declaration of Conformity null and void and relieve the manufacturer of all liability under civil and criminal law.

#### 4.4 Main components

- B1 Adjustable spray nozzle
- B5 High pressure hose

#### B2 Lance

#### B3 Gun with safety catch

B6 Detergent tank (on models with this feature)

#### B4 Power supply cable with plug (on models with this feature)

#### 4.4.1 Accessories (if included in the supply package – see fig.1).

#### C1 Nozzle cleaning tool

#### C2 Rotating nozzle kit

#### C3 Handle

#### C4 Brush

#### C5 Hose reel

#### C6 Water suction kit

#### C7 Pipe drain kit

#### C8 Large surface cleaning tool

#### C9 Adapter

#### C10 Lubricating grease tube

(where supplied)

#### 4.5 Safety devices



#### Caution - Danger!

**Do not tamper with or adjust the safety valve setting.**

- Safety valve and/or pressure limiting valve.

The safety valve is also a pressure limiting valve.

When the gun trigger is released, the valve opens and the water recirculates through the pump inlet or is discharged onto the ground.

- **Thermostat valve (D1 where fitted)**

If the water temperature exceeds the temperature set by the manufacturer, the thermostat valve discharges the hot water and draws in an amount of cold water equal to the amount of water discharged, until the correct temperature is restored.

- Safety catch (D): prevents accidental spraying of water.

### 5 INSTALLATION (FIG.2)/PAGE 4

#### 5.1 Assembly



#### Caution - Danger!

**All installation and assembly operations must be performed with the appliance disconnected from the mains power supply.**

The assembly sequence is illustrated in fig.2.

#### 5.2 Assembling the rotating nozzle

(For models with this feature)

The rotating nozzle kit delivers greater washing power.

Use of the rotating nozzle may cause a reduction in pressure of 25% compared to the pressure obtained with the adjustable nozzle. However, the rotating nozzle kit delivers greater washing power due to the rotation of the water jet.

#### 5.3 Electrical connection



#### Caution - Danger!

**Check that the electrical supply voltage and frequency (V-Hz) correspond to those specified on the appliance data plate (fig.2). The appliance should only be connected to a mains power supply equipped with an adequate earth connection and a differential security breaker (30 mA) to cut off the electricity supply in the instance of a short circuit.**

##### 5.3.1 Use of extension cables

Use cables and plugs featuring "IPXS" protection level.

The cross-section of the extension cable should be proportionate to its length; the longer it is, the greater its cross-section should be. See table 1/PAGE 6.

#### 5.4 Water supply connection



#### Caution - Danger!

**Only clean or filtered water should be used for intake. The delivery of the water intake tap should be equal to that of pump capacity.**

Place the appliance as close to the water supply system as possible.

##### 5.4.1 Connection points

- Water outlet (OUTLET)

- Water inlet with filter (INLET)

##### 5.4.2 Connection to the mains water supply

The appliance can be connected directly to the mains drinking water supply only if the supply hose is fitted with a backflow preventer valve as per current regulations in force. Make sure that the hose is at least Ø 13 mm and that it is reinforced.



**6 ADJUSTMENT INFORMATION (FIG.3)/PAGE 5**

- 6.1 Adjusting the spray nozzle** (for models with this feature)  
Water flow is adjusted by regulating the nozzle (E).
- 6.2 Adjusting the detergent** (on models with this feature)  
Detergent flow is adjusted using the regulator (F).
- 6.3 Adjusting the detergent pressure**  
Set the adjustable nozzle (E) on "■" to deliver detergent at the correct pressure (on models with this feature).
- 6.4 Adjusting the pressure** (on models with this feature)  
The regulator (G) is used to adjust the working pressure. The pressure is shown on the pressure gauge (where fitted).

**7 INFORMATION ON USE OF THE APPLIANCE (FIG.4)/PAGE 5****7.1 Controls**

- Starter device (H).

Set the starter switch on (ON/1) to:

- start the motor (in models without TSS device);
  - set the motor ready to start (in models with TSS device).
- If there is a pilot light on the starter device, it should light up. If the "low/high" settings are available, use them as follows:

Low : low pressure washing

High : high pressure washing

Set the starter device switch on (OFF/0) to shut down the appliance.

If there is a pilot light on the starter device, it should go out.

- Water jet control lever (I).

**Caution - Danger!**

During operation the appliance must be positioned as shown in fig. 4 on a sturdy, stable surface.

**7.2 Start-up**

- Turn on the water supply tap fully.
- Release the safety catch (D).
- Depress the gun trigger for a few seconds and start up the appliance using the starter device (ON/1).

**Caution - Danger!**

Before starting up the appliance check that the water supply hose is connected properly; use of the appliance without water will damage it; do not cover the ventilation grilles when the appliance is in use.

**TSS models** - In TSS models with automatic delivery flow cut-off system:

- when the gun trigger is **released** the dynamic pressure automatically cuts out the motor (see fig.4);
- when the gun trigger is **depressed** the automatic drop in pressure starts the motor and the pressure is restored after a very slight delay;
- if the TSS is to function correctly all gun **releasing** and **depressing** operations must be performed at intervals **not less** than 4-5 seconds at least.

On three-phase models **for professional use**: at first use, start the appliance for a very short time to check that the motor is running in the correct direction. If the motor fan is turning anti-clockwise, exchange two of the three phase wires (L1, L2, L3) in the electrical plug.

**To prevent damage to the appliance, do not allow it to operate dry and when running do not stop the water jet for more than 10 minutes at a time (for models without TSS device).**

**7.3 Stopping the appliance**

- Set the starter device switch on (OFF/0).
- Depress the gun trigger and discharge the residual pressure inside the hoses.
- Engage the gun safety catch (D).

**7.4 Restarting**

- Release the safety catch (D).
- Depress the gun trigger and discharge the residual air inside the hoses.

- Set the starter device on (ON/1).

**7.5 Storage**

- Switch the appliance off (OFF/0).
- Remove the plug from the socket.
- Turn off the water supply tap.
- Discharge the residual pressure from the gun until all the water has come out of the nozzle.
- Drain and wash out the detergent tank at the end of the working session. To wash out the tank, use clean water instead of the detergent.
- Engage the gun safety catch (D).

**7.6 Refilling and using detergent**

**When using detergent, the adjustable nozzle must be set on "■" (on models with this feature).**

Use of a high pressure hose longer than the one originally supplied with the cleaner, or the use of an additional hose extension, may reduce or completely halt the intake of detergent.

Fill the tank with highly degradable detergent.

**7.7 Recommended cleaning procedure**

Dissolve dirt by applying the detergent mixed with water to the surface while still dry.

When dealing with vertical surfaces work from the bottom upwards. Leave the detergent to act for 1-2 minutes but do not allow the surface to dry. Starting from the bottom, use the high pressure jet at a minimum distance of 30 cm. Do not allow the rinse water to run onto unwashed surfaces.

In some cases, scrubbing with brushes is needed to remove dirt.

High pressure is not always the best solution for good washing results, since it may damage some surfaces. The finest adjustable nozzle jet setting or the rotopower nozzle should not be used on delicate or painted parts, or on pressurised components (e.g. tyres, inflation valves, etc.).

Effective washing depends on both the pressure and volume of the water used, to the same degree.

**8 MAINTENANCE (FIG.5)/PAGE 6 - (FIG.6)/PAGE 144**

Any maintenance operations not covered by this chapter should be carried out by an Authorized Sales and Service Centre.

**Caution - Danger!**

Always disconnect the plug from the power socket before carrying out any work on the appliance.

**8.1 Cleaning the nozzle**

- Disconnect the lance from the nozzle.
- Remove any dirt deposits from the nozzle hole using the tool (C1).

**8.2 Cleaning the filter**

Inspect the intake filter (L) and detergent filter (if fitted) before each use, and clean in accordance with the instructions if necessary.

**8.3 Unjamming the motor** (on models with this feature)

In case of lengthy stoppages, limescale sediments may cause the motor to seize. To unjam the motor, turn the drive shaft with a tool (M).

**8.4 End-of-season storage**

Treat the appliance with non-corrosive, non-toxic antifreeze and lubricate the O-rings using the lubricating grease tube (where supplied) (C10) as shown before storing it away for winter.

Put the appliance in a dry place, protected from frost.





## Technical Data

Technical Data (EN)	Unit	490
Output	l/min	7
Pressure	MPa	12
Maximum pressure	MPa	14
Power	kW	2,1
T <sup>°</sup> input	°C	50
Maximum input pressure	MPa	1
Repulsive force of the gun to the maximum pressure	N	18,1
Motor Insulation	-	Class F
Motor Protection	-	IPX5
Voltage	V/Hz	
Maximum allowed net impedance	Ω	0,08
Sound level K= 3 dB(A) :		
L <sub>WA</sub> (EN 60704-1)	dB (A)	84,5
L <sub>WA</sub> (EN 60704-1)	dB (A)	92
Unit vibrations K= 1,5 m/s <sup>2</sup> :	m/s <sup>2</sup>	3,74
Weight	kg	18,8

*Subject to technical modifications!*

## WARRANTY INFORMATION

Crommelins Machinery warrants their goods against defects in materials and workmanship under normal use and service.

The Crommelins Machinery warranty does not cover fair wear commensurate with the age of the product, any damage caused by accident, abuse, misuse, neglect or failure to observe proper operating instructions or proper machinery maintenance as described in the instruction manual. The warranty does not cover components subject to normal wear (valves, pistons, water gasket, oil gasket, springs, O-rings, accessories such as hoses, guns, brushes wheels, etc.)

It is the owners responsibility to regularly maintain a product in accordance to the owners manual and only use the equipment for its designed purpose.

Our goods come with guarantees that cannot be excluded under the Australian Consumer Law. You are entitled to a replacement or refund for a major failure and for compensation for any other reasonably foreseeable loss or damage. You are also entitled to have goods repaired or replaced if the goods fail to be of acceptable quality and the failure does not amount to a major failure.

### 1 YEAR DOMESTIC USE WARRANTY

This DOMESTIC USE product comes with a 1 year Crommelins manufacturers warranty.

## CONSUMER ADVICE

Any claim under these warranties must be made within warranty period from the date of purchase of the product.

Refer to [www.crommelins.com.au](http://www.crommelins.com.au) or contact 1300 650 659 for the location of your nearest authorised warranty repair agent.

To make a claim under the warranty, you must return the product (with proof of purchase) to the closest warranty agent or to the place of purchase.

Where a failure does not amount to a major failure, Crommelins Machinery is entitled to choose between providing you with a repair, replacement or refund. To obtain compensation, you would need to provide documentary evidence of the loss or damage suffered, and documentary evidence that such loss or damage was a reasonably foreseeable consequence of a failure by Crommelins Machinery to comply with a consumer guarantee under the Australian Consumer Law.

Crommelins Operations Pty Ltd T/A Crommelins Australia and Crommelins Machinery.

ABN 11 008 889 656  
PO Box 352, BENTLEY WA 6982

Ph: (08) 9350 5588 Fax: (08) 9451 6381  
[email@crommelins.com.au](mailto:email@crommelins.com.au)





Crommelins Operations Pty Ltd T/A  
Crommelins Australia and  
Crommelins Machinery.

ABN 11 008 889 656  
PO Box 352, BENTLEY WA 6982

Ph: (08) 9350 5588  
Fax: (08) 9451 6381  
[email@crommelins.com.au](mailto:email@crommelins.com.au)